

EXAMINATION CHAIR Model 2500-CH

RIGHTmed
S4OPTIK



S4OPTIK

FEATURES:

- ◆ **automated MOTORISED RECLINE**
precision engineered Motorised Auto Recline System extends from seated to supine position or any position in between.
- ◆ **convenient MEMBRANE BUTTONS**
recline, return or stop: all are achieved easily by a simple press of a membrane switch mounted on both sides of the chair.
- ◆ **strong, yet silent POWER LIFT & RECLINE SYSTEM**
powered with Swiss designed linear actuator for smooth and virtually silent lifting, capable of 500lb (227 kg) capacity. The chair seat raises to 32" (81.2cm) and lowers to 24" (60.9cm).
- ◆ **intelligent ROTATION/LOCK**
foot actuated Rotation Lock provides a firm positive lock. Accessible from both sides of the chair, our unique design eliminates operator bending or reaching.
- ◆ **sensible HEIGHT CONTROL LOCATIONS**
height adjustment controls accessible from the slit lamp arm, stand console (when paired with a S4OPTIK Instrument Stand), or movable foot switch.
- ◆ **convenient FOOT CONTROL**
robust foot switch provides raise/lower control for chair height adjustment.

- ◆ **advanced HEADREST**

single handed control for easy positioning of the Headrest, insuring head and neck support. Engineered for a positive, non-slip lock in any location.



SPECIFICATIONS

Measurements

Base	20" (50.8 cm) wide x 26" (66.04 cm) depth
Seat	20" (50.8 cm) width, lower limit 24", upper limit 32"
Footrest	13" (33.02 cm) wide x 8" (20.3 cm) depth.
Shipping Weight	286 lbs (129.72 kg)

TECHNOLOGY
VALUE
RELIABILITY



- ◆ **functional ARMRESTS**

upholstered armrests are individually retractable for maximum flexibility. Solid construction provides safe support for ingress/egress.



- ◆ **robust FOOT REST**

a large, broad and stable foot rest provides safe and easy ingress/egress. Easily able to withstand the full weight of the patient and conveniently retracts when not required.

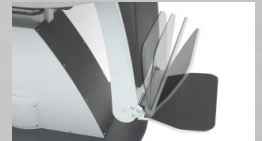

CHAIR UPRIGHT

CHAIR RECLINED

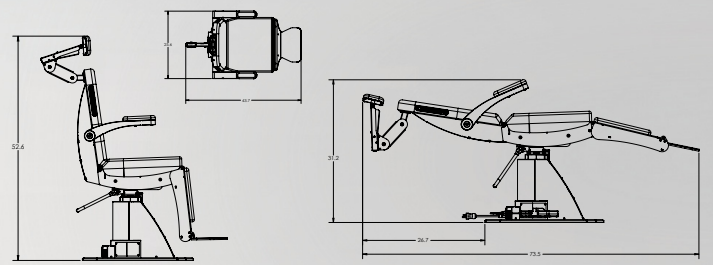

Distributed by:

with a policy of continuous improvement, we reserve the right to make changes to specifications without advance notice.

RIGHTmed
S4OPTIK

5325 Cleveland Street, Suite 303 Virginia Beach, VA 23462
1.888.224.6012 | www.s4optik.com